

**ELECTRICAL SYSTEM NOTES:**

- LICENSED ELECTRICIANS REGISTERED IN THE MUNICIPALITY SHALL DO ALL WORK IN ACCORDANCE WITH THE LOCAL AND NATIONAL ELECTRICAL CODE. ELECTRICIAN SHALL PROVIDED AN UNDERWRITER'S CERTIFICATE AT THE CONCLUSION OF WORK.
- ELECTRICIAN SHALL COMPLETE HIS PART OF THE BUILDING PERMIT APPLICATION. IF MUNICIPALITY REQUIRES LOAD CALCULATIONS OR DIAGRAMS, THEN ELECTRICAL CONTRACTOR SHALL PROVIDE.
- SOME RECEPTACLES ARE INDICATED TO BE "ISOLATED HOME RUNS" FOR SPECIAL USE. THESE CIRCUITS, GENERALLY FOR AUDIO-VISIO OR COMPUTER LOCATIONS, SHALL BE LOCATED "FIRST" OR AT THE TOP OF THE DISTRIBUTION PANEL TO MINIMIZE INTERFERENCE OR "ELECTRICAL NOISE".
- THE MINIMUM WIRE SIZE FOR RECEPTACLES SHALL BE 12 GA., THE MINIMUM WIRE SIZE FOR LIGHTING SHALL BE 14 GA., ALL COPPER. ALL CIRCUITS SHALL BE GROUNDED.
- LAMPING: ALL NEW FIXTURES SHALL HAVE THE APPROPRIATE LAMP INSTALLED.
- IF OWNER DOES NOT PROVIDE OR APPROVE A LIGHT FIXTURE AT TIME OF FINAL ELECTRICAL INSPECTION, THEN INSTALL SIMPLE PORCELAIN SOCKETS AND BULB.
- ELECTRICAL DEVICE DESIGN SHALL BE "DECORA" BY LEVITON, OR APPROVED EQUAL. ALL FACE PLATES SHALL BE MATCHING PLASTIC. ALL DEVICES TO BE WHITE. MOUNTING HEIGHTS, IN GENERAL, USE RECOMMENDATIONS IN THE "ADA" GUIDELINES.
- ARCHITECT'S DRAWINGS ONLY SHOW ELECTRICAL NOTES, DEVICE LOCATIONS, AND CONTROL SCHEMATICS. THE ELECTRICIAN SHALL DO ALL CIRCUIT & LOAD DISTRIBUTION DESIGN. DISTRIBUTION PANEL SHALL BE CLEARLY LABELED.
- SEPARATE POWER CIRCUITS FROM LIGHTING CIRCUITS. DO NOT MAXIMIZE CIRCUIT CAPACITY, INSTEAD MAXIMIZE CLARITY OF ORGANIZATION AND SAFETY FOR THE OWNER. DESIGN CIRCUITS SUCH THAT THERE IS ONE (1) BREAKER PER ROOM FOR POWER, LIGHTING MAY BE MORE THAN A SINGLE ROOM, BUT SHALL BE INTELLIGENT ZONES. MAJOR EQUIPMENT, INCLUDING REFRIGERATORS, SHOULD HAVE DEDICATED CIRCUITS.
- PROVIDE NEW 200 AMP SERVICE AND PANEL. NEW MAIN PANEL TO BE DIVIDED WITH MANUAL TRANSFER SWITCH, WITH SECTION RESERVED FOR "CRITICAL LOADS", THEN ROUGH IN FOR FUTURE EMERGENCY GENERATOR AT LOCATION SHOWN.
- PROVIDE PANEL LARGE ENOUGH FOR THE WORK SHOWN, AND PROVIDE MINIMUM 6 SPARE 20 AMP BREAKERS. ALL BREAKERS SHALL BE FULL SIZE, NOT HALF-SIZE.
- PROVIDE SUB-PANEL IN GARAGE.
- FOR OWNER'S APPROVAL, BEFORE WORK BEGINS, SUBMIT CATALOG CUTS FOR ALL FIXTURES, APPLIANCES, DEVICES, SWITCHES, ETC.
- COORDINATE WITH THE HVAC CONTRACTOR AND PLUMBING CONTRACTOR TO PROVIDE SERVICE TO ALL EQUIPMENT AS REQUIRED.
- ALL HOLES DRILLED INTO TOP OR BOTTOM WALL PLATES, INTERIOR AND EXTERIOR, SHALL BE SEALED, USE EXPANDABLE FOAM TO PREVENT VERTICAL PASSAGE OF AIR.
- LABEL ALL CIRCUITS IN PANEL.

INDEX OF DRAWINGS	
1	ARCHITECTURAL SITE PLAN
2	BASEMENT & FOUNDATIONS
3	FIRST FLOOR PLAN
4	SECOND FLOOR PLAN
5	EXTERIOR ELEVATIONS: NORTH AND SOUTH
6	EXTERIOR ELEVATIONS: EAST AND WEST
7	HOUSE SECTION: 1/2" SCALE, EAST INTERIOR WALL
8	HOUSE SECTION: 1/2" SCALE, WEST INTERIOR WALL
9	WALL SECTIONS & CONSTRUCTION MATERIALS
10	ELECTRICAL: FIRST FLOOR & SITE
11	ELECTRICAL: BASEMENT & SECOND FLOOR

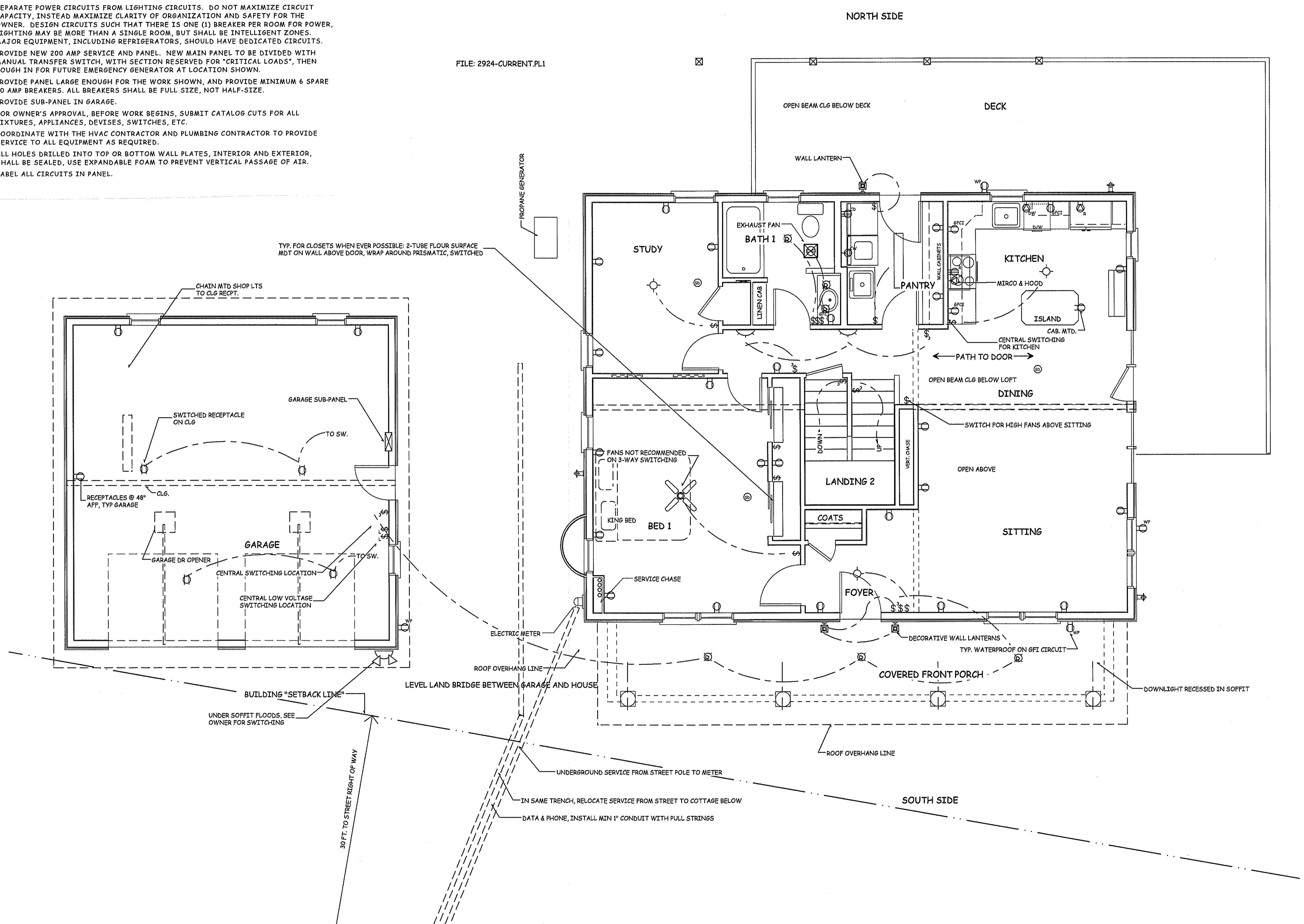

**ELECTRICAL - FIRST FLOOR & SITE**

SCALE 1/4" = 1'-0"

DATE	REVISION DESCRIPTION
FEB. 02, 2011	START UP
NOV. 15, 2011	PRELIMINARY
DEC. 16, 2011	ESTIMATING & TRADE INPUT
FEB. 03, 2012	REVIEW
FEB. 03, 2012	FOR PERMITS
JULY 12, 2012	

ONLY VALID FOR PERMITS w/ EMBOSSED SEAL & ORIGINAL "RED" SIGNATURE

HOUSE & GARAGE ARE BOTH PRESENTED IN THIS SET OF DRAWINGS. HOWEVER WILL BE SEPARATE PROJECTS.

Eric C. Van Reed, Architect  
**Creative Design Associates, Inc.**  
 ARCHITECTURE INTERIORS SITE & SPACE PLANNING  
 350 Callowhill Road  
 Chalfont, PA 18914  
 Voice: 215-872-1155  
 www.ArchitectVision.com

**NEW PRIVATE RESIDENCE**  
 TAMARACK ROAD  
 NICHOLSON TWP, WYOMING CO., PENNSYLVANIA  
 DEED BOOK 162, PAGE 654, TAX ID # 79.0-500, 5.228 ACRES

ELECTRICAL