

**ATTIC PLAN**

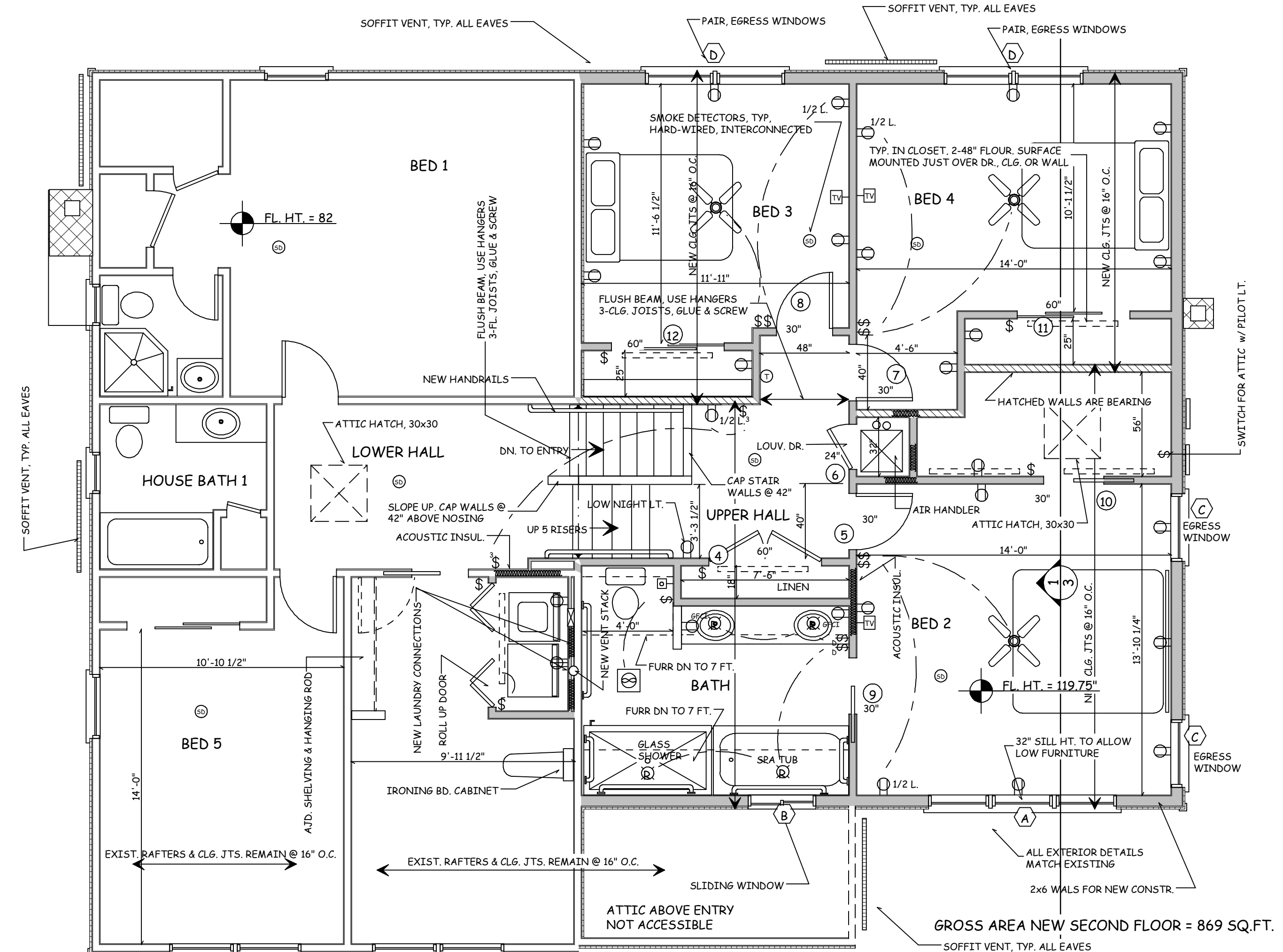

**SECOND FLOOR PLAN**

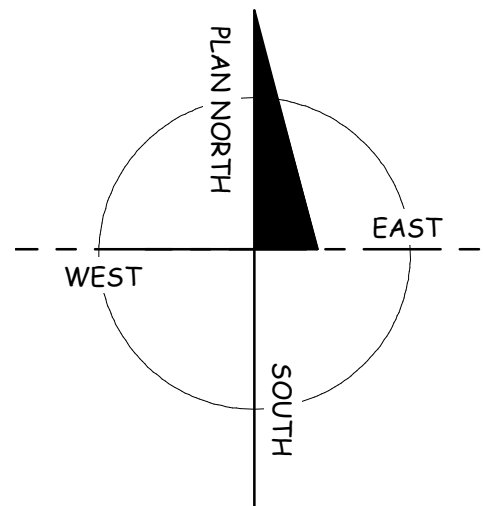
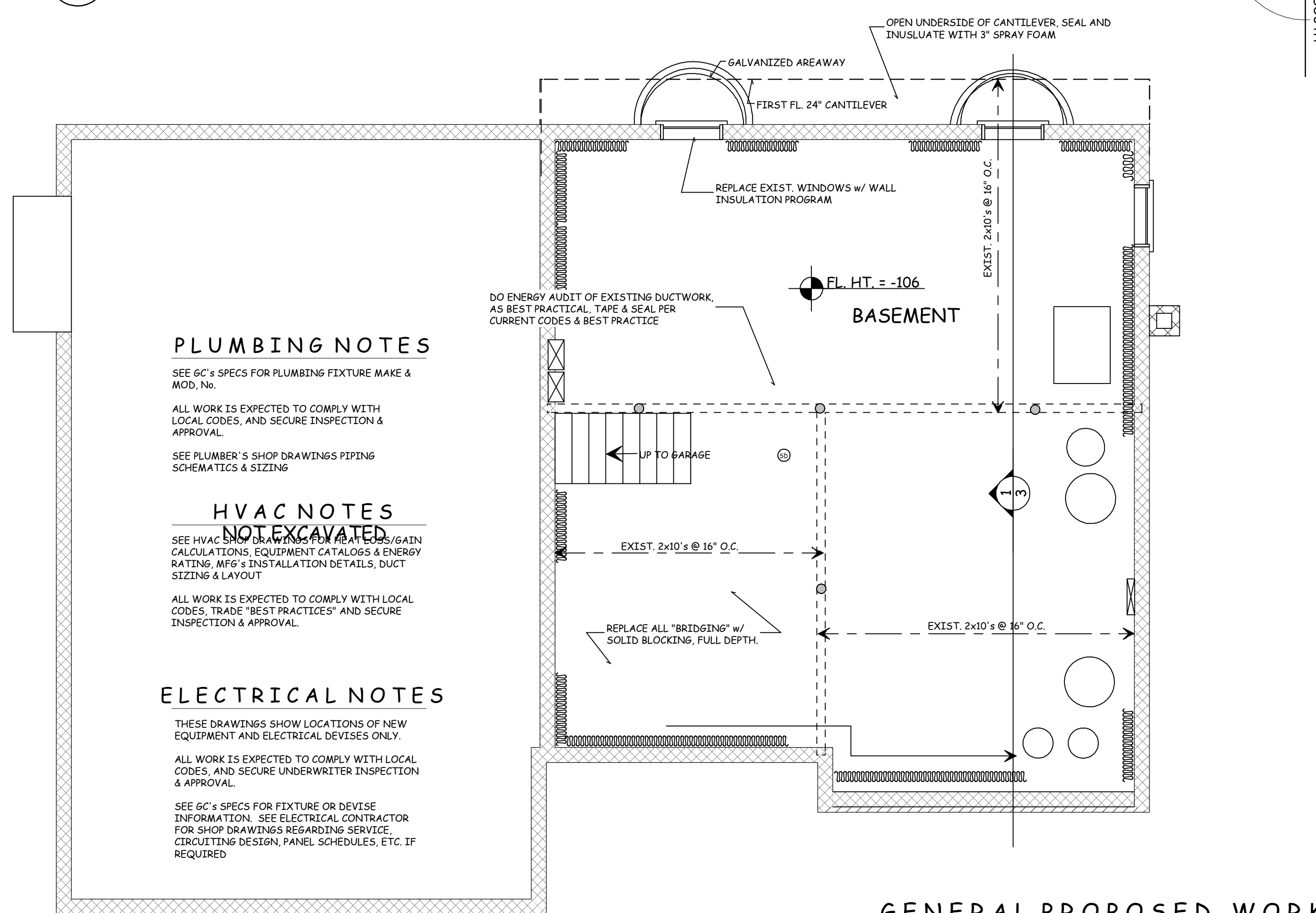

**BASEMENT PLAN**

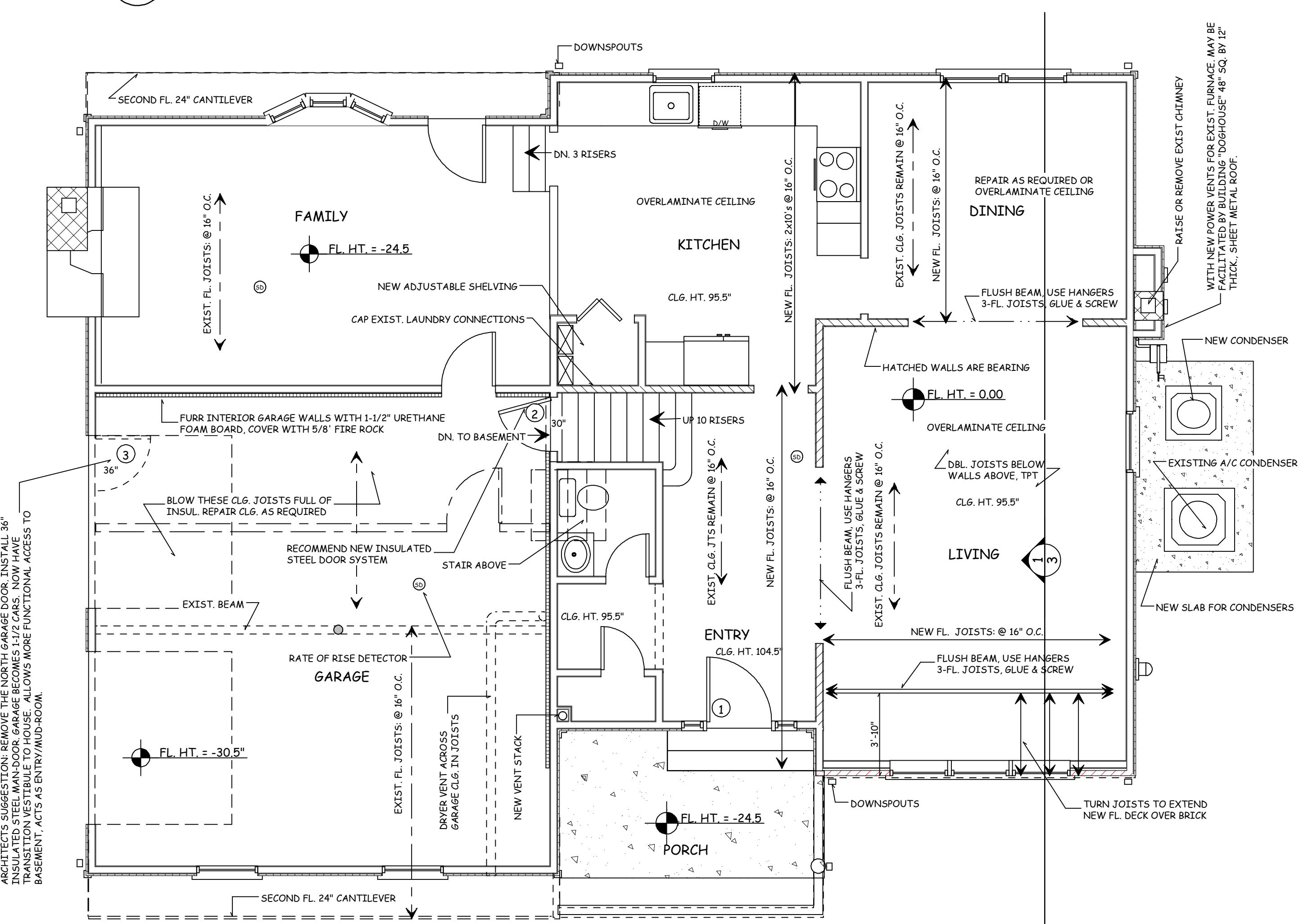

**FIRST FLOOR PLAN**

REV.#	REVISION DESCRIPTION	DATE
1	INTRO TO CLIENT	APRIL 26, 2013
2	PROJECT START UP	JUNE 27, 2013
3	UPDATES/IN BATH-REVISIONS	FEB. 10, 2014
4	FOR PERMITS	MARCH 03, 2014

PLANS NOT VALID FOR PERMITS UNLESS SIGNED IN 'RED' & IMPRESSED w/ SEAL

**Eric C. Van Reed, Architect**  
NJ Reg: 21A100908100  
ARCHITECTURE INTERIORS SITE & SPACE PLANNING  
350 Callowhill Road  
Chalfont, PA 18914  
215-672-1155  
www.ArchitectVision.com

**Creative Design Associates, Inc.**  
ARCHITECTURE INTERIORS SITE & SPACE PLANNING  
350 Callowhill Road  
Chalfont, PA 18914  
215-672-1155  
www.ArchitectVision.com

**Ryden Construction**  
General Construction  
NJ Reg: H.C. 33VH06099300  
113 Oak Ave.  
Chalfont, PA 18914  
215-822-9239  
RydenConstruction.com

**114 HOWARD WAY**  
ADDITIONS & ALTERATIONS  
Pennington, 08534  
Hopewell Township, Mercer Co., NJ