

CONTINUOUS LOAD PATH ANCHOR SYSTEM

ALL PRODUCTS SHOWN BY SIMPSON STRONG-TIE

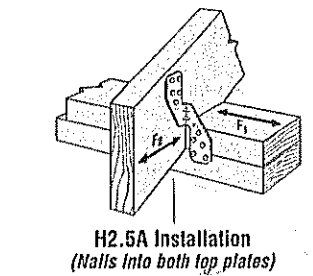

RAFTER TO TOP PLATE

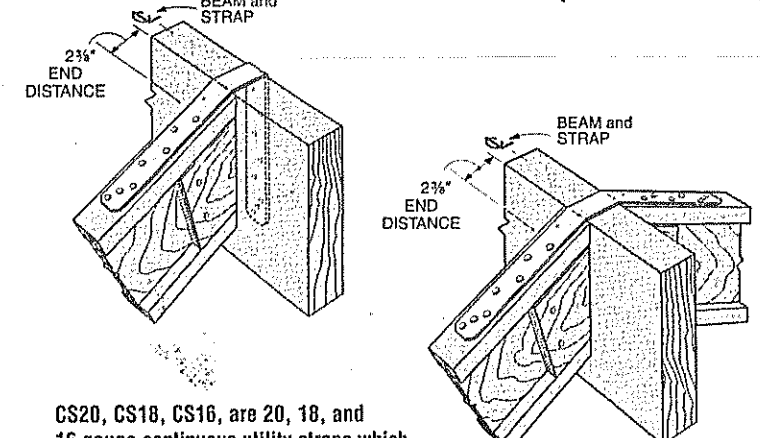

CS20, CS18, CS16, and 20, 18, and 16 gauge continuous utility straps which are cut to length on site.
Minimum Cut Length in inches = $6\frac{1}{2} + (2\frac{1}{4} \times (\# \text{ of nails into each rafter}) + (\text{Ridge width}))$

RAFTERS AT RIDGE BEAM

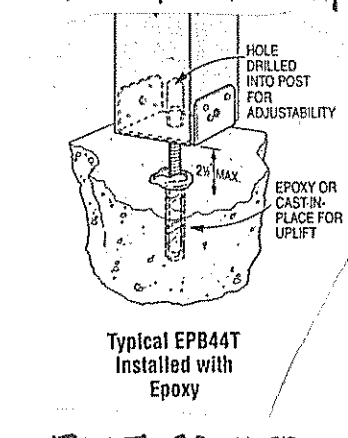

POST ANCHOR

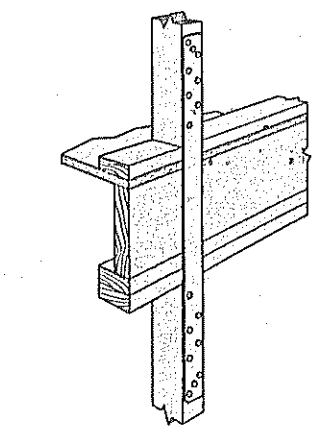

LSTA Strap Tie

WALL CONTINUITY ANCHOR

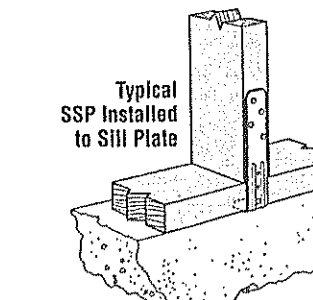
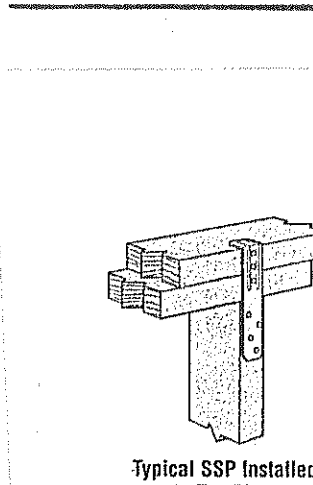
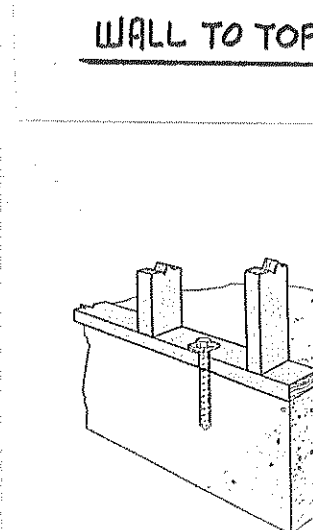

PLATE TO WALL



WALL TO TOP PLATE



TITEN HD[®] Mechanically Galvanized[®] SILL PLATE TO FOUNDATION

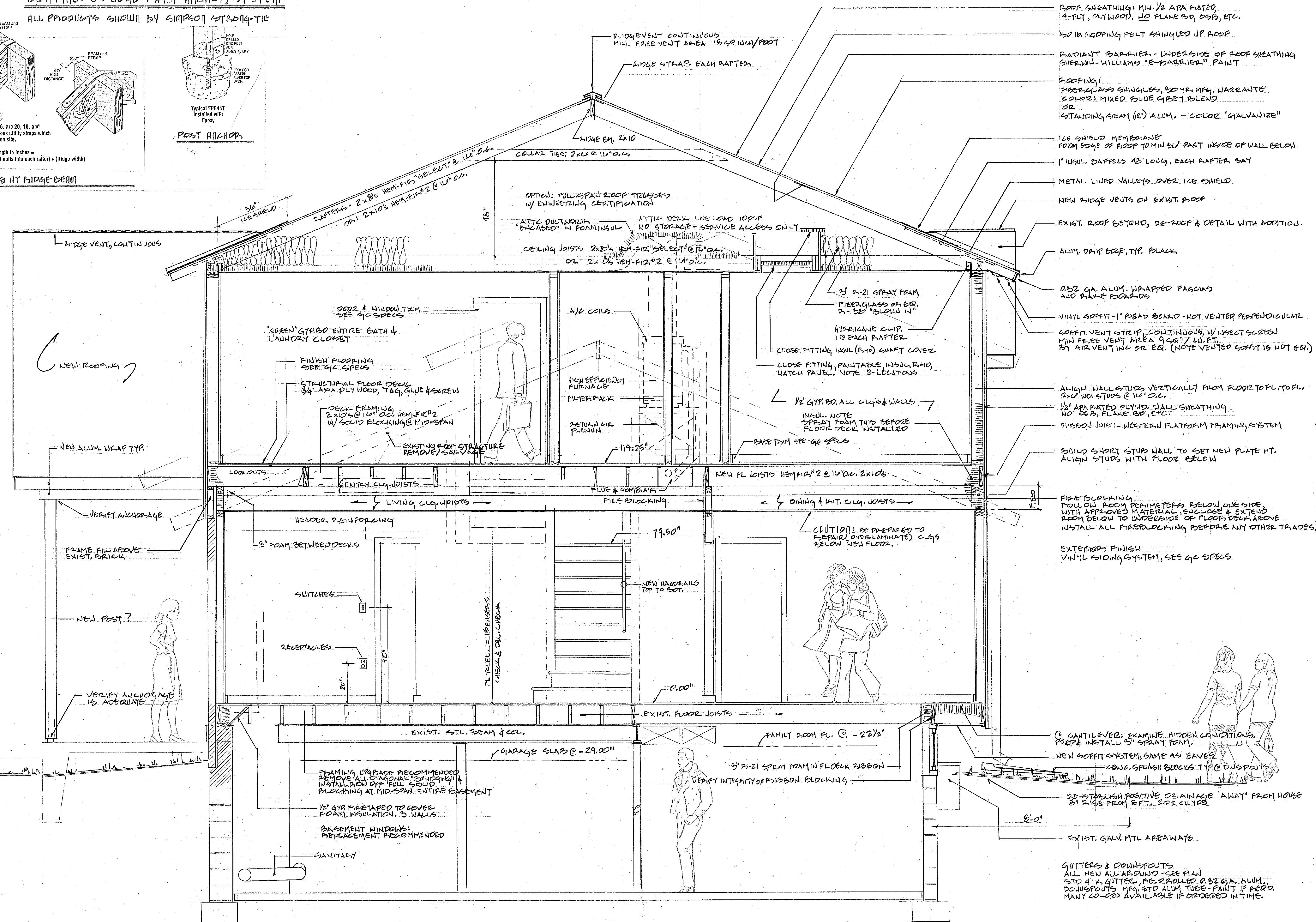

- ROOF SHEATHING: MIN. 1/2" APA PATED, 4-PLY, PLYWOOD. NO FLAKE BD, OSB, ETC.
- 30 LB. ROOFING FELT SHINGLED UP ROOF
- RADIANT BARRIER - UNDERSIDE OF ROOF SHEATHING SHERWIN-WILLIAMS "E-BARRIER" PAINT
- ROOFING: FIBERGLASS SHINGLES, 30 YR. MFG. WARRANTED COLOR: MIXED BLUE GREY BLEND OR STANDING SEAM (2") ALUM. - COLOR "GALVANIZE"
- ICE SHIELD MEMBRANE FROM EDGE OF ROOF TO MIN 5L" PAST INSIDE OF WALL BELOW
- 1" INSUL. BAFFLES 48" LONG, EACH RAFTER BAY
- METAL LINED VALLEYS OVER ICE SHIELD
- NEW RIDGE VENTS ON EXIST. ROOF
- EXIST. ROOF BEYOND, RE-ROOF & DETAIL WITH ADDITION.
- ALUM. DRIP EDGE, TYP. BLACK
- 0.32 GA. ALUM. WRAPPED FASCIA AND PLANK BOARDS
- VINYL GOSFIT-1" BEAD BOARD - NOT VENTER PERPENDICULAR
- GOSFIT VENT STRIP, CONTINUOUS, W/ INSECT SCREEN MIN FREE VENT AREA 9 SQ" / L.F.T. BY AIR VENTING OR EQ. (NOTE VENTED GOSFIT IS NOT EQ.)
- ALIGN WALL STUDS VERTICALLY FROM FLOOR TO FL. TO FL. 24" HD. STUDS @ 16" O.C.
- 1/2" APA PATED PLYWD. WALL SHEATHING NO OSB, FLAKE BD, ETC.
- SISSON JOINT - WESTERN PLATFORM FRAMING SYSTEM
- BUILD SHORT STUD WALL TO SET NEW PLATE HT. ALIGN STUDS WITH FLOOR BELOW
- FIRE BLOCKING FOLLOW ROOM PERIMETERS BELOW ONE SIDE WITH APPROVED MATERIAL ENCLOSE & EXTEND ROOM BELOW TO UNDERSIDE OF FLOOR DECK ABOVE INSTALL ALL FIREBLOCKING BEFORE ANY OTHER TRADES.
- EXTERIOR FINISH VINYL SIDING SYSTEM, SEE GC SPECS
- CAUTION: BE PREPARED TO REPAIR (OVERLAMINATE) CLGS BELOW NEW FLOOR.
- NEW GOSFIT SYSTEM, SAME AS EAVES
- CONC. SPLASH BLOCKS TYPE D/SPOUTS
- RE-ESTABLISH POSITIVE DRAINAGE "AWAY" FROM HOUSE 8" RISE FROM 8FT. 201 CU. YDS
- EXIST. GAW. MTL AREAWAYS
- GUTTERS & DOWNSPOUTS ALL NEW ALL AROUND - SEE PLAN STD 4" GUTTER, FIELD ROLLED 0.32 GA. ALUM. DOWNSPOUTS MFG. STD ALUM TUBE - PAINT IF PER. MANY COLORS AVAILABLE IF ORDERED IN TIME.

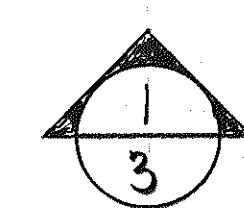

CONSTRUCTION SECTION

SCALE 1/2" = 1'-0"

DATE	REVISION DESCRIPTION
APRIL 26, 2013	INTRO TO CLIENT
JUNE 27, 2013	PROJECT START UP
APRIL 10, 2014	UPDATES / AM. BATH REVISIONS
FEB. 10, 2014	

PLANS NOT VALID FOR PERMITS UNLESS SIGNED IN RED & IMPRESSED W/ SEAL

Eric C. Van Reed, Architect
 NJ Reg. 21A00908100
Creative Design Associates, Inc.
 ARCHITECTURE INTERIORS SITE & SPACE PLANNING
 350 CALLEVA III ROAD
 CHALFONT, PA 18814
 215-672-1155
 www.Architectvision.com

Ryden Construction
 General Construction
 NJ Reg. HIC.13VH0609900
 215-822-8238
 RydenConstruction.com
 113 Oak Ave
 Chalfont, PA 18814

114 HOWARD WAY
ADDITIONS & ALTERATIONS
 Hopewell Township, Mercer Co., NJ

Sheet No. **3**
 Comm. No. 2013-2974 of